

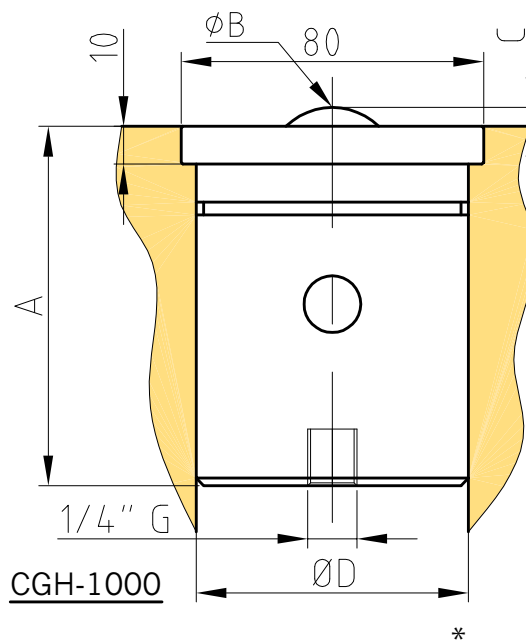

Retractable roller cartridge

- Operating pressure 100 bar.
- Allow to create rolling paths where no suitable DIN slot is present.
- CGH models bodies can be made on request with different shape.

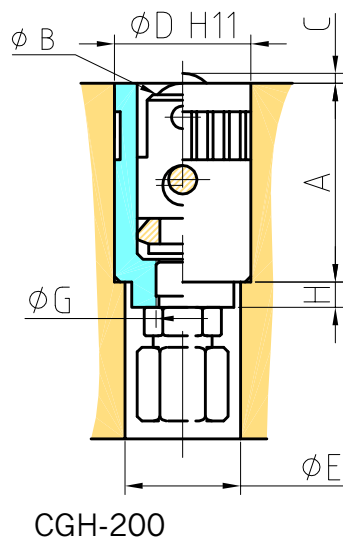

* Roller bearing

** hydraulic port can be also made as UNF thread, UNF 7/16" for G1/8", UNF 9/16" for G1/4".

	CGH-200	CGH-1000
F _(kN)	2.00	10.00
P _{max} (bar)	100	1000
A	48	95
ØB	16	35
C	3	5
ØD	35	72
ØE	20	
ØG**	1/8"	1/4"
H	6	

ordering reference : CGH XX

XX: strength in kN. For special shape bodies, please add S suffix.