

### LINK CSP

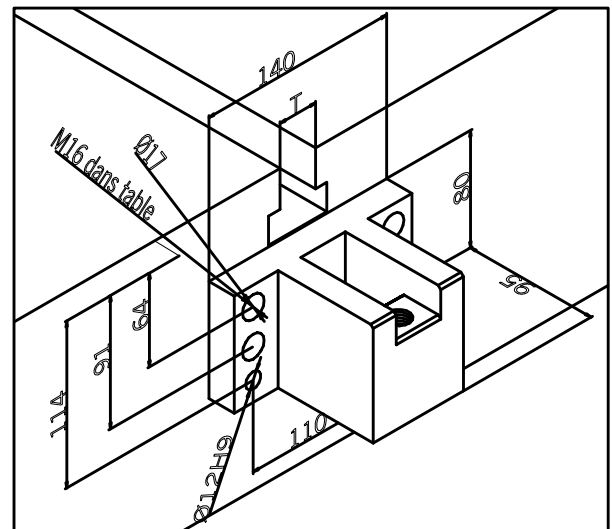

Type	P kg	L	A	H	ØD	N
CSP 3000	3000	1200	1280	210	40	19
CSP 6000	6000	1500	1580	220	40	46
	6000	2000	2080	410	40	62
CSP 10000	10000	2000	2080	410	40	62
	10000	2500	2580	410	40	80

The height and layout of the link blocs is designed to make room for a DIN 650 T28 slot at the axis.

The dimensions for fixing the link blocks are shown from the raised height of the ball or roller bars, if fitted, or from the bolster surface if otherwise

P (kg) : Max rolling load for a pair of bolster extensions

ordering reference : CSP XXX-YYYY

XXX : strength in kN    YYYY: length